

vtech[®]

User's Manual

Jungle Fun Music Box™



© 2009 VTech

Printed in China

91-002347-000-000 (美)

Dear Parent,

Ever notice the look on your baby's face when they learn something new through their own discovery? These self-accomplished moments are a parent's greatest reward. To help fulfill them, **VTech**[®] created the **Infant Learning**[®] series of toys.

These unique interactive learning toys directly respond to what children do naturally – play! Using innovative technology, these toys react to baby's interactions, making each play experience fun and unique as they learn age-appropriate concepts like first words, numbers, shapes, colors and music. More importantly, **VTech**[®]'s **Infant Learning**[®] toys develop baby's mental and physical abilities by inspiring, engaging and teaching.

At **VTech**[®], we know that a child has the ability to do great things. That's why all of our electronic learning products are uniquely designed to develop a child's mind and allow them to learn to the best of their ability. We thank you for trusting **VTech**[®] with the important job of helping your child learn and grow!

Sincerely,

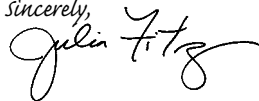

Julia Fitzgerald
Vice President, Marketing
Vtech Electronics, NA

To learn more about the **Infant Learning**[®] and other **VTech**[®] toys, visit www.vtechkids.com

INTRODUCTION

Thank you for purchasing the **VTech® Jungle Fun Music Box™**.

The **VTech® Jungle Fun Music Box™** is a fun musical toy that will introduce your child to instruments and their sounds through sound effects and sing along songs! Spin the knob around to see the fun giraffe character dance and spin to the entertaining melodies, as the giraffe gets faster and faster so will the tempo of the playing melody. Press the giraffe and its animal friends to hear fun sound effects and music.



INCLUDED IN THIS PACKAGE

- One VTech® Jungle Fun Music Box™
- One instruction manual

WARNING: All packing materials, such as tape, plastic sheets, packing lockers, wire ties and tags are not part of this toy, and should be discarded for your child's safety.

Unlock the packing locker:

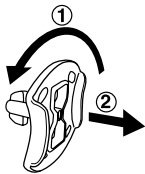

- ① Rotate the packing locker counter-clockwise
- ② Pull out the packing locker and discard

GETTING STARTED

BATTERY INSTALLATION

1. Make sure the unit is turned **OFF**.
2. Locate the battery cover on the bottom of the unit. Use a coin or screwdriver to loosen the screw.
3. Install 3 new 'AA' size (AM-3/LR6) batteries following the diagram inside the battery box. (The use of new alkaline batteries is recommended for maximum performance.)
4. Replace the battery cover and tighten the screw to secure.

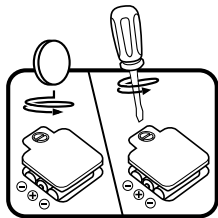

BATTERY NOTICE

- The use of new alkaline batteries is recommended for maximum performance.
- Install batteries correctly observing the polarity (+, -) signs to avoid leakage.
- Do not mix old and new batteries.
- Do not mix batteries of different types: alkaline, standard (carbon-zinc) or rechargeable (nickel-cadmium).
- Remove the batteries from the equipment when the unit will not be used for an extended period of time.
- Always remove exhausted batteries from the equipment.
- Do not dispose of batteries in fire.
- Do not attempt to recharge ordinary batteries.
- The supply terminals are not to be short-circuited.
- Only batteries of the same and equivalent type as recommended are to be used.

WE DO NOT RECOMMEND THE USE OF RECHARGEABLE BATTERIES.



PRODUCT FEATURES

1. ON/OFF BUTTON

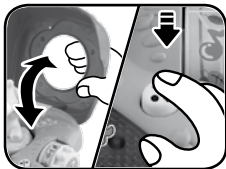
Press the **ON/OFF BUTTON** () once to turn the unit on. Press the **ON/OFF BUTTON** a second time to turn the unit off. Alternatively, open the lid to turn the unit on and close the lid to turn the unit off.



2. VOLUME CONTROL SWITCH

To adjust the volume, slide the **VOLUME CONTROL SWITCH** to the () **LOW VOLUME** position or the () **HIGH VOLUME** position.

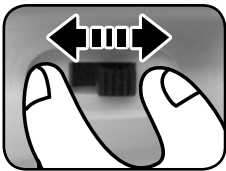

3. AUTOMATIC SHUT-OFF

To preserve battery life, the **VTech® Jungle Fun Music Box™** will automatically power-down after approximately 30 seconds without input. The unit can be turned on again by pressing any button or by spinning the handle.

ACTIVITIES

1. Press the **on/off button** or open the lid to turn the unit on. You will hear a fun phrase, sing along song and a melody. The light will flash with the sound.

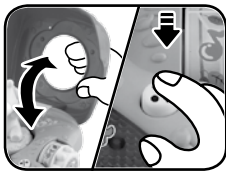

2. Press the **maraca button** or **drum button** to hear the instrument names, fun phrases, sound effects and melodies. The light will flash with the sound.



3. Press the **spinning giraffe** to hear a fun phrase and sing along song or 3 random melodies. While a melody is playing, press the spinning giraffe, a funny giraffe sound will sing the current melody. Press the maraca button or drum button to interrupt the melody and give the related button response. The light will flash with the sound.

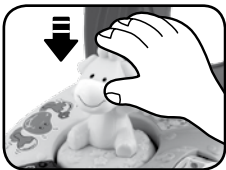

4. Spin the **spinning knob** to hear a random melody. Continue turning the knob to increase the tempo of the melody. The giraffe will turn the same direction the knob is turned. The light will flash with the sound.

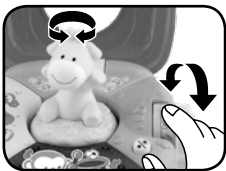

MELODY LIST

1. Humpty Dumpty
2. Sing a Song of Sixpence
3. Hey, Diddle Diddle
4. Sailing, Sailing
5. BINGO
6. Ta-ra-ra Boom-de-ay
7. Blue Danube Waltz
8. The Magic Flute
9. Rock-a-Bye
10. Greensleeves
11. Beautiful Dreamer

12. Ode to Joy
13. Flute Quartet No.2
14. Moonlight Sonata
15. Happy Farmer
16. New World Symphony
17. All Through the Night

SONG LYRICS

Song 1 (To the tune of “Twinkle, Twinkle, Little Star”)

Spinning, twirling everywhere,
When the music fills the air.

Song 2

I'm a very friendly giraffe!
Singing out loud for all to hear.

CARE & MAINTENANCE

1. Keep the unit clean by wiping it with a slightly damp cloth.
2. Keep the unit out of direct sunlight and away from any direct heat source.
3. Remove the batteries when the unit is not in use for an extended period of time.
4. Do not drop the unit on hard surfaces and do not expose the unit to moisture or water.

TROUBLESHOOTING

If for some reason the program/activity stops working or malfunctions, please follow these steps:

1. Please turn the unit **OFF**.
2. Interrupt the power supply by removing the batteries.
3. Let the unit stand for a few minutes, then replace the batteries.
4. Turn the unit **ON**. The unit should now be ready to play again.
5. If the product still does not work, replace with a new set of batteries.

If the problem persists, please call our Consumer Services Department at 1-800-521-2010 in the U.S. or 1-877-352-8697 in Canada, and a service representative will be happy to help you.

For information on this product's warranty, please call **VTech**® 1-800-521-2010 in the U.S., or 1-877-352-8697 in Canada.

IMPORTANT NOTE:

Creating and developing **Infant Learning** products is accompanied by a responsibility that we at **VTech**® take very seriously. We make every effort to ensure the accuracy of the information, which forms the value of our products. However, errors sometimes can occur. It is important for you to know that we stand behind our products and encourage you to call our Consumer Services Department at 1-800-521-2010 in the U.S. or 1-877-352-8697 in Canada, with any problems and/or suggestions that you might have. A service representative will be happy to help you.

Note:

This equipment has been tested and found to comply with the limits for a Class B digital device, pursuant to Part 15 of the FCC Rules. These limits are designed to provide reasonable protection against harmful interference in a residential installation. This equipment generates, uses

and can radiate radio frequency energy and, if not installed and used in accordance with the instructions, may cause harmful interference to radio communications. However, there is no guarantee that interference will not occur in a particular installation. If this equipment does cause harmful interference to radio or television reception, which can be determined by turning the equipment off and on, the user is encouraged to try to correct the interference by one or more of the following measures:

- Reorient or relocate the receiving antenna
- Increase the separation between the equipment and receiver
- Connect the equipment into an outlet on a circuit different from that to which the receiver is connected
- Consult the dealer or an experienced radio/TV technician for help

THIS DEVICE COMPLIES WITH PART 15 OF THE FCC RULES. OPERATION IS SUBJECT TO THE FOLLOWING TWO CONDITIONS: (1) THIS DEVICE MAY NOT CAUSE HARMFUL INTERFERENCE, AND (2) THIS DEVICE MUST ACCEPT ANY INTERFERENCE RECEIVED, INCLUDING INTERFERENCE THAT MAY CAUSE UNDESIRE OPERATION.

THIS CLASS B DIGITAL APPARATUS COMPLIES WITH CANADIAN ICES-003.

CET APPAREIL NUMÉRIQUE DE LA CLASSE B EST CONFORME À LA NORME NMB-003 DU CANADA.

Caution : Changes or modifications not expressly approved by the party responsible for compliance could void the user's authority to operate the equipment.